

Rigid Endoscopy in Cattle

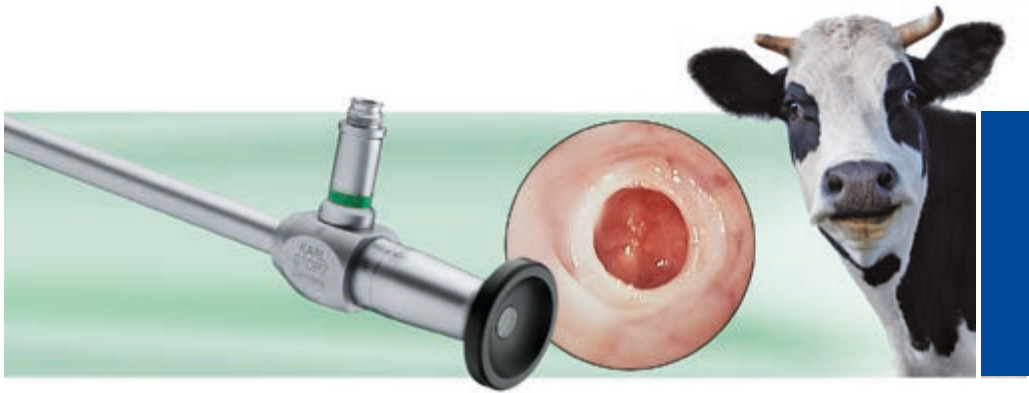

SEEH/HOSPES Theloresectoscopy Set

Developed with the Clinic for Obstetrics and Andrology of Large and Small Animals, with Veterinary Ambulatory, Justus-Liebig-University Giessen, 1st Professor's Chair: Prof. Dr. Dr. h.c. H. Bostedt

KARL STORZ has developed the first theloresectoscope (teat endoscope with integrated electrosurgical working element) for minimally invasive teat surgery and diagnostics in the standing cow.

The new instrument set makes it possible to enter the teat **via the streak canal** or with a **lateral single puncture approach**.

With either approach, visual examination can be performed as well as the resection of tissue that occludes the streak canal. An assistant is not required to perform the

procedure. The clinician can position the instruments in such a way that the entire operating field is in view throughout the procedure, making it simple even for the novice endoscopist.

The removal of obstructive tissue via theloresectoscopy has been shown to reduce post-operative complications and costs compared to thelotomy removal.



SEEH/HOSPES Theloresectoscopy Set

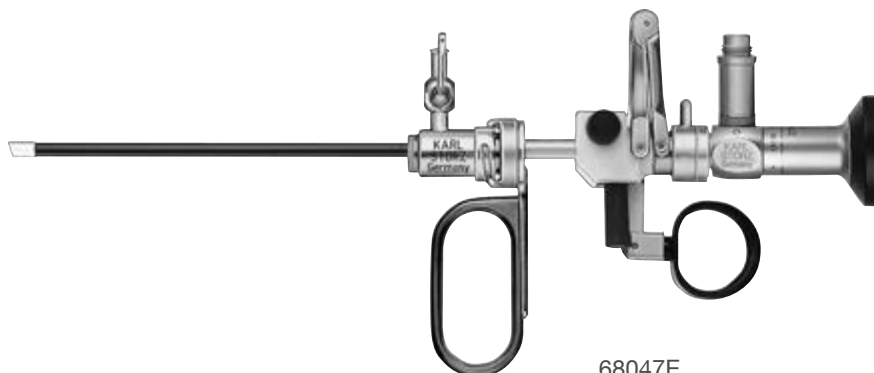

68047E

- 64017AA **HOPKINS® Straight Forward Telescope 0°, autoclavable**, diameter 1.9/2.1 mm, length 18 cm, fiber optic light transmission incorporated, color code: green
- 68045EA **SEEH/HOSPES Theloresectoscope**
including:
1x **Working Element**
2x **Coagulation Electrode**
1x **High Frequency Cord**
1x **Protection Tube**
- 68047E **Sheath**, with LUER-Lock connector for insufflation, diameter 11 Fr.
- 68048EH **Trocar**
including:
Cannula
Obturator, blunt
Obturator, conical
- 20400040 **Silicone Tubing Set**
- 600007 **LUER-Lock Tube Connector**, male, tube diameter 6 mm

Unipolar High Frequency Cord for use with Working Element 68045E:

- 277 **Unipolar High Frequency Cord**, with 4 mm plug for models KARL STORZ and Erbe type T, older models, length 300 cm
- 277A **Unipolar High Frequency Cord**, with 4 mm plug for models Berchtold and Martin, length 300 cm
- 277KE **Unipolar High Frequency Cord**, with 5 mm plug for AUTOCON® II 400 SCB (111, 115, 122, 125), AUTOCON® II 200, AUTOCON® II 80, KARL STORZ AUTOCON® (series 50, 200, 350) and Erbe type ICC, length 300 cm
- 277KB **Unipolar High Frequency Cord**, with 8 mm plug for models KARL STORZ AUTOCON® II 400 SCB system (112, 116) and Valleylab, length 300 cm

Laparoscopic Abomasopexy

An increasing number of reported left abomasal displacements (LDAs) in high production dairy cows suggests the potential for significant economic advantage to new technologies that treat the condition most effectively. Laparoscopic-assisted toggle pin placement offers the opportunity to treat the cow faster and with reduced morbidity compared to conventional open surgical procedures. The laparoscopic procedure also minimizes the risk of inadequate toggle placement. It combines the advantages of laparotomy (control of reposition and fixation) and the roll and suture treatment (quick, minimally invasive).

With the cow in a standing position, the laparoscope is inserted into the left paralumbar fossa and the abomasum is identified. Then under laparoscopic guidance, the cannula for toggle placement is inserted into the abomasum and the toggle is

inserted through the trocar. The procedure can be finished in dorsal recumbency with caudolateral trocar placement, or the instrument for toggle placement (68160LS) can be used for completing this procedure in standing position. The laparoscope is then placed caudolateral to the xyphoid. Through a second portal caudal to the first one, a grasping forceps is inserted to grasp the sutures and exteriorize them. After 3 – 4 weeks, the sutures can be cut.

The KARL STORZ abomasopexy set combines an excellent optical system with high quality instruments and toggle. The toggle is extra strong with very smooth suture holes, so that the risk of abomasal rupture at the suture site is minimized.



Set for Laparoscopic Repositioning of Abomasal Displacement

HOPKINS® Enlarged view

Multiple puncture approach
Trocar size 11 mm

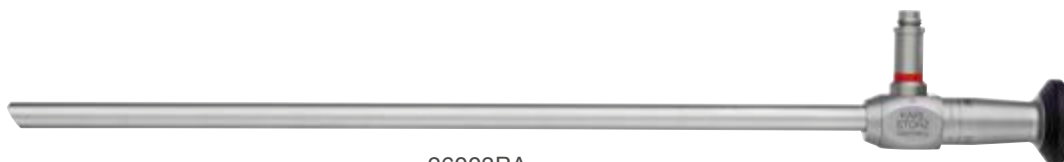

26003BA



HOPKINS® Forward-Oblique Telescope 30°, enlarged view, diameter 10 mm, length 31 cm, **autoclavable**, fiber optic light transmission incorporated, color code: red

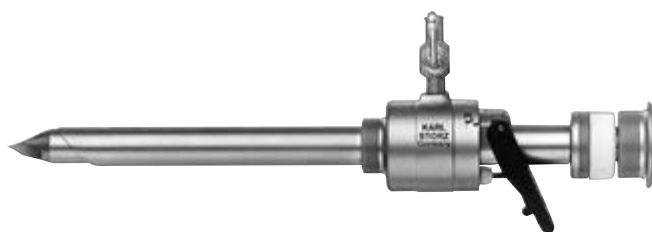

62103MP

Trocar, size 11 mm, color code: green including:
Trocar only, with pyramidal tip
Cannula, without valve, with insufflation stop cock, working length 10.5 cm
Multifunctional Valve, size 11 mm

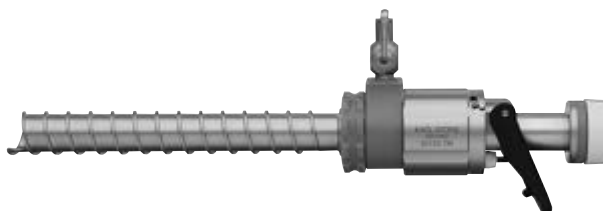

60103TMR

TERNAMIAN EndoTIP Cannula, with thread and rotatable insufflation stopcock, size 11 mm, working length 10.5 cm, color code: green including:
Cannula
Multifunctional Valve
Seal Set 60/10
Mandrel, for opening automatic valves

Instruments for Toggle Placement



68160X

68160X **Cannula**, for toggle placement, diameter 5 mm, length 37 cm



68160XS **Obturator**, sharp, for Cannula 68160X



68160XT **Obturator**, blunt, for Cannula 68160X, for use as toggle pusher



68100T **Toggle**, for abomasal fixation, package of 6 pieces

Instrument for performing the procedure in a standing cow



68160LS **Suture Securing Instrument**, complete, including:
Sheath, distal part
Sheath, proximal part
Knife, distal part
Knife, proximal part

Instrument for performing the procedure in a standing cow



11301D4 **Battery Light Source LED for Endoscopes**, with fast screw thread, boost mode for temporary increase in brightness, burning time > 120 min, brightness > 110 lm / > 150 klx, weight approx. 150 g ready for use, suitable for wipedisinfection, for use with KARL STORZ endoscopes

Transvaginal Embryo Transfer

Since bovine embryo transfer has become a routine procedure, there is a need for easy access to the bovine ovaries.

The transvaginal approach to the abdomen is one which allows free access to the bovine oviduct, facilitating the routine transfer of early tubal-stage embryos. The outer tube is placed with the blunt obturator caudodorsal to the cervix, then the blunt obturator is replaced by the sharp obturator and introduced through the vaginal wall into the peritoneal cavity.

Next, the specially designed telescope with the inner sheath is placed through the outer tube, and the camera is connected. Now you have free access to the oviduct and can manipulate the ovaries per rectum.

The bovine embryo transfer set is uniquely designed in cooperation with the Institute for Agrarbiotechnology in Tulln, Austria (IFA-Tulln) to the ideal specifications for this procedure, facilitating rapid and effective implementation of ET.

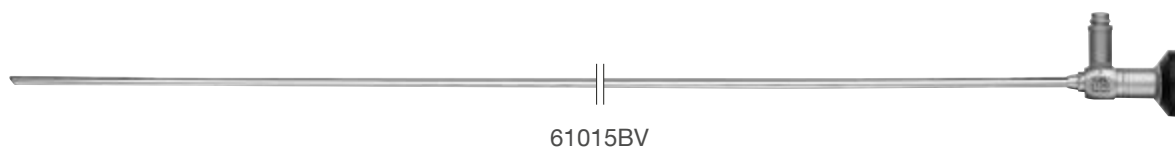

HOPKINS® Forward-Oblique Telescope 30°, diameter 5.5 mm, length 54 cm, fiber optic light transmission incorporated, color code: red



Universal Sheath, with stopcock for insufflation, diameter 12.5 mm, working length 49.5 cm, with blunt Obturator 66016EB



Obturator, blunt, for Universal Sheath 66016EA



Obturator, with pyramidal tip, for Universal Sheath 66016EA



Obturator, with conical tip, for Universal Sheath 66016EA

66016B

Inner Sheath, with working channel for transfer catheter, for use with Universal Sheath 66016EA



More than
75
Years

*Shaping the Future
of Endoscopy with you*

STORZ
KARL STORZ—ENDOSKOPE

THE DIAMOND STANDARD

KARL STORZ SE & Co. KG
Dr.-Karl-Storz-Straße 34, 78532 Tuttlingen/Germany
Postbox 230, 78503 Tuttlingen/Germany
Phone: +49 7461 708-0
Fax: +49 7461 708-105
E-Mail: vet@karlstorz.com

www.karlstorz.com

